

DEALER NAME

 End Customer :
 Address
 Zip code + City
 Country
 Email :

5/9/2023

COMMISSION N°

NAUTITECH 40 OPEN

BASED ON BUILDER STANDARD SPECIFICATIONS AUGUST 4TH 2023

	Prix € HT	Qté	Total
Base Price Ex Works - 3 Cabins / 2 Heads	444.350,00 €	0	
Base Price Ex Works - 4 Cabins / 2 Heads	450.800,00 €	0	
COMFORT VERSION	25.900,00 €	0	
EXPLORER VERSION	49.900,00 €	0	

Version configuration	COMFORT	EXPLORER
Anchor windlass (electric) with wired remote, 1000W	●	●
Cockpit shower with hot/cold water on Stb	●	●
Two Forward pulpits with seats in natural wood	●	●
Lazy bag	●	●
Davits and cleats for tender	●	●
Mooring Kit (6 Fenders, 4 mooring lines)	●	●
Upgrade electrical system with battery for Service 2 x 12V/140 Ah incl. 32A shorepower, system 230V with plugs in all cabins, saloon and galley + battery charger 40Ah + galvanic isolator	●	●
Pack USB plugs (1 double plug per cabin)	●	●
Delta anchor 20 kg, galvanized, chain Ø 10mm, length 60m with crow's feet	●	●
Mosquito screens for all hatches on deck	●	●
Fabric covered bed frame	●	●
Upgrade for leather covered handrail in the companion way	●	●
FUSION audio system with 4 speakers	●	●
Fixed Cockpit table in GRP	●	●
Electrical winch for mainsail halyard at helm station Stb.	Option	●
Cushions for cockpit	Option	●
Gennaker reacher 70sqm incl. sheets	Option	●
Bowsprit, dynema halyard, furler, blocks and stoppers for gennaker	Option	●
Full cockpit enclosure with doors	Option	●
External sun shades for saloon windscreen with opening	Option	●

OPTIONS

		Qté	Total
MOTORISATION			
2 x 50hp diesel engines Volvo Penta (Saildrive)	5.775,00 €	0	- €
2 x 3-blade folding propellers for 30hp engine, bronze	3.100,00 €	0	- €
2 x 3-blade folding propellers for 50hp engine, bronze	3.890,00 €	0	- €
Electronic throttle control on both helmstations	10.900,00 €	0	- €

NAVIGATION EQUIPMENT			
Name of boat on Lazy bag	490,00 €	0	- €
Black painted mast and boom	5.700,00 €	0	- €
Upgrade square main sail	1.200,00 €	0	- €
Hydranet main and fore sail (replaces standard sails)	14.150,00 €	0	- €
Hydranet square main sail and solent (replaces standard sails)	15.350,00 €	0	- €
Code 0 55m² incl. sheets (upwind sail)	4.980,00 €	0	- €
Gennaker reacher 70sqm incl. sheets	3.790,00 €	0	- €
Asymmetric spinnaker 123sqm incl. Sheets, with socks	5.980,00 €	0	- €
Bowsprit, dynema halyard, furler, blocks and stoppers (for gennaker, spinnaker)	5.990,00 €	0	- €
Code 0 gear (only in combination with Gennaker gear)	1.280,00 €	0	- €
Electrical winch LEWMAR for mainsail halyard at helm station Stb.	3.890,00 €	0	- €
Manual winch LEWMAR for mainsheet, Port.	1.590,00 €	0	- €
Anchor windlass remote control with chaincounter at helm station	990,00 €	0	- €

UPHOLSTERY & LIFESTYLE

Inside range choice			
Upgrade comfort mattress (3c version)	2.100,00 €	0	- €
Upgrade comfort mattress (4c version)	2.800,00 €	0	- €
Saloon cushions Standard			
□ Eden Nutmeg	Standard		
□ Eden Pebble			
□ Eden Shadow			
□ Eden Midnight			
Saloon cushions Ultraeather			
□ White	790,00 €	0	- €
□ Beige			

<input type="checkbox"/> Taupe				
Saloon cushions Leather	2.190,00 €	0		- €
<input type="checkbox"/> Sand				
<input type="checkbox"/> Cappuccino				
<input type="checkbox"/> Slate Gray				
Outside color choice:	Optionnal			
<input type="checkbox"/> Eden Nutmeg				
<input type="checkbox"/> Eden Pebble				
<input type="checkbox"/> Eden Shadow				
<input type="checkbox"/> Eden Midnight				
Signature Nautitech				
Upgrade for In&Out SIGNATURE Upholstery with decorative cushions	2.390,00 €	0		- €
Set of custom bedding for 3 cabin-version (including cushions and duvet)	2.250,00 €	0		- €
Set of custom bedding for 4 cabin-version (including cushions and duvet)	3.000,00 €	0		- €
Set of 6 bathroom towels – white with Nautitech Manta Ray embroidery (2 guests, 2 toilets and 2 baths) - unit price per set	290,00 €	0		- €
Set of 6 socks for fender - Black with white Nautitech embroidery	560,00 €	0		- €
Upgrade of gennaker with printing of Nautitech Manta Ray (gold) and 40 (black)	2.900,00 €	0		- €
Hull decoration with Manta Ray (gold)	2.100,00 €	0		- €
EXTERIOR EQUIPMENT				
Deck/Cockpit				
FLEXITEEK in cockpit and aft platforms	11.900,00 €	0		- €
Frontdeck Lounge: Bar/storage box with integrated cupholders, foldable 3 part cushions convertible into lounge area	4.270,00 €	0		- €
Full cockpit enclosure with doors	3.900,00 €	0		- €
Additional sun net for cockpit enclosure (only together with cockpit enclosure)	1.410,00 €	0		- €
External sun shades for saloon windscreen with opening	2.030,00 €	0		- €
Bimini on helmstation (per unit)	1.700,00 €	0		- €
Helmstation protection cover (per unit)	530,00 €	0		- €
Cushions for cockpit seats and aft bench	4.410,00 €	0		- €
Upgrade Cockpit table convertible into lounge area (upholstery included)	1.990,00 €	0		- €
Upgrade Cockpit table in natural wood 10 pers (1,73m X 0,79m)	1.660,00 €	0		- €
INTERIOR EQUIPMENT				
Blinds for cabin hull windows	1.910,00 €	0		- €
Desk configuration in the owner cabin	2.180,00 €	0		- €
Salon dining table convertible into lounge bed (incl. cushion)	1.870,00 €	0		- €
Extra berth in portside forepeak incl. mattress, gelcoat finishing, ventilation, light and access to front cabin (only with 4 Cabin version)	1.890,00 €	0		- €
Extra berth in starboard forepeak incl. mattress, gelcoat finishing, ventilation, light and access to front cabin	1.890,00 €	0		- €
COMFORT & APPLIANCES				
Watermaker 60 L/h 12V (brand Dessalator)	17.900,00 €	0		- €
Electrical sea water pump	790,00 €	0		- €
Fridge in cockpit 65L, 12V	2.700,00 €	0		- €
Freezer 55L 12V	2.170,00 €	0		- €
Washing machine 3kg 220V (3 cabin version only - not available in 110V)	2.590,00 €	0		- €
Microwave oven 220V	330,00 €	0		- €
Fans 12V (1 per cabin / 2 in saloon)	1.490,00 €	0		- €
Reversible air-conditioning 230V (cooling+heating function for Owner version)	30.960,00 €	0		- €
Complete system with outlet in salon and one in each cabin				
Reversible air-conditioning 230V (cooling+heating function for 4 cabins version)	33.390,00 €	0		- €
Complete system with outlet in salon and one in each cabin				
Heating system, complete system with outlet in each cabin + saloon + cockpit	19.170,00 €	0		- €
Electrical toilet, seawater flush (per unit - specify location)	1.100,00 €	0		- €
Electrical toilet, freshwater flush (per unit - specify location)	1.250,00 €	0		- €
ELECTRICITY & LIGHTING				
1 Additional service battery 140A + 1 battery charger 40 Ah	2.090,00 €	0		- €
Inverter 2000W connected to boardnet incl. Switch	2.590,00 €	0		- €
(Additional service batterie 140A and charger 40A compulsory)				
Lithium batteries 630Ah instead of AGM batteries	13.990,00 €	0		- €
Indirect lighting in saloon	995,00 €	0		- €
Courtesy LED lights white in cockpit and aft deck	1.300,00 €	0		- €
Two LED spreader lights	1.210,00 €	0		- €
Two LED spotlights under the bridgedeck	2.110,00 €	0		- €
Underwaterlighting 4 x 21W white	4.290,00 €			
Solar Panels 4x100W on davits	5.090,00 €			
Solar Panels 4x180W on the roof	5.600,00 €	0		- €
Solar Panels 8x180W on the roof	11.200,00 €	0		- €
Generator Onan 6KW (starboard forepeak not compatible)	23.900,00 €	0		- €
ELECTRONIQUE ET MULTIMEDIA				
Nav-Pack Cruise	14.800,00 €	0		- €
2 x B&G Triton Displays (1 x per helmstation) with Speed-, Depth-, Wind-Transducer				
2 x B&G Zeus 9" chartplotter (stb & port helmstations)				
Chartplotter functionality on B&G Zeus 9" at nav station				
B&G Autopilot, B&G Autopilot control unit (stb helmstation)				
B&G V100 VHF incl. Antenna (nav station)				
B&G AIS Transmitter/Receiver				
B&G H50 wireless VHF unit (stb helmstation)				
Nav-Pack Advanced	16.880,00 €	0		- €
<i>includes Nav-Pack Cruise plus additional</i>				
1 x extra B&G Autopilot control unit (port helmstation)				
B&G Forward scan				
B&G 4G Radar antenna	3.190,00 €	0		- €
Pre installation for TV (antenna incl. plug) in saloon	980,00 €	0		- €
60 HZ OPTIONS				
Upgrade Electrical system 110V 60Hz	2.630,00 €	0		- €
Inverter 2000W 110V connected to boardnet incl. Switch	2.610,00 €	0		- €
(Additional service batterie 140A and charger 40A compulsory)				
Reversible air-conditioning 110V (cooling+heating function for Owner version)	36.460,00 €	0		- €
Complete system with outlet in salon and one in each cabin				

Reversible air-conditioning 110V (cooling+heating function for 4 cabins version)	38.390,00 €	0	- €
Complete system with outlet in salon and one in each cabin			
Generator Onan 7,5KVA/60Hz under 110V (starboard forepeak not compatible)	25.300,00 €	0	- €
Pre installation for TV 110V (antenna incl. plug) in saloon	980,00 €	0	- €
SAFETY EQUIPMENT AND DELIVERY			
Dinghy 3,1m (Highfield UL310 Hypalon) with 10hp Honda outboard engine	10.880,00 €	0	- €
Life raft cat. A with security pack for 10 crew (except EPIRB)	4.990,00 €	0	- €
Antifouling INTERNATIONAL PRO 250 (3 layers)	4.730,00 €	0	- €
Antifouling PLATINIUM (3 layers)	6.190,00 €	0	- €
Copper coat	8.910,00 €	0	- €
Delivery in La Rochelle incl. transport, launching, rigging (1 week Marina fees incl.)	8.950,00 €	0	- €
Loading in Rochefort : preparation for sea freight incl. shrink wrap, mast in 2 parts and mast cradles	6.250,00 €	0	- €
Administrative papers for custom exit	480,00 €	0	- €
Administrative papers for apostille or notarized document (per demande and per document)	150,00 €	0	- €
Total excl. VAT			- €

20% deposit at order	- €
20% two months before delivery	- €
Balance 15 days before loading date EX Yard	- €

Estimated date of delivery :(will be confirmed upon reception of order):

REMARKS : Official schedule payment will be precised when delivery date will have been determinated.

COMMENTS :

Requested delivery date:

**REMARK : Upon receipt of our order confirmation, please check and advise immediatly if any discrepancies.
The boat will be built according to this order confirmation**

The undersigned declares to agree with the order form and to accept general sales conditions to approve them and to buy the goods above.

NAUTITECH CATAMARANS SAS

The Customer

Signature with "read and approved" mention

All prices are in EUROS EX Works Rochefort (17300 - France) Incoterms 2020

Version S2_2023 - Valid from SEPTEMBER 1ST 2023

Date of issue : AUGUST 4TH 2023 - all previous price lists lose their validity

Minimal configuration required

We, Nautitech, reserve the right to modify or improve our products and to change its specifications and/or prices without notice. We, Nautitech, are not liable for errors and printing mistakes. Aforementioned prices are recommended sales prices, not contractual. All modifications of orders are subject to invoicing according to the then valid price list. Final price may be subject to a price adjustment based on a notified Index. The current price includes the Ecotax APER.

NAUTITECH 40 OPEN



Base Price Ex Works - 3 Cabins / 2 Heads

Price excl. VAT. EUROS
444.350,00 €

Base Price Ex Works - 4 Cabins / 2 Heads

450.800,00 €

COMFORT VERSION

25.900,00 €

EXPLORER VERSION

49.900,00 €

Version configuration	COMFORT	EXPLORER
Anchor windlass (electric) with wired remote, 1000W	●	●
Cockpit shower with hot/cold water on Stb	●	●
Two Forward pulpits with seats in natural wood	●	●
Lazy bag	●	●
Davits and cleats for tender	●	●
Mooring Kit (6 Fenders, 4 mooring lines)	●	●
Upgrade electrical system with battery for Service 2 x 12V/140 Ah incl. 32A shorepower, system 230V with plugs in all cabins, saloon and galley + battery charger 40Ah + galvanic isolator	●	●
Pack USB plugs (1 double plug per cabin)	●	●
Delta anchor 20 kg, galvanized, chain Ø 10mm, length 60m with crow's feet	●	●
Mosquito screens for all hatches on deck	●	●
Fabric covered bed frame	●	●
Upgrade for leather covered handrail in the companion way	●	●
FUSION audio system with 4 speakers	●	●
Fixed Cockpit table in GRP	●	●
Electrical winch for mainsail halyard at helm station Stb.	Option	●
Cushions for cockpit	Option	●
Gennaker reacher 70sqm incl. sheets	Option	●
Bowsprit, dynema halyard, furler, blocks and stoppers for gennaker	Option	●
Full cockpit enclosure with doors	Option	●
External sun shades for saloon windscreen with opening	Option	●

MOTORISATION		Price excl. VAT EUROS
<input type="checkbox"/>	2 x 50hp diesel engines Volvo Penta (Saildrive)	5.775,00 €
<input type="checkbox"/>	2 x 3-blade folding propellers for 30hp engine, bronze	3.100,00 €
<input type="checkbox"/>	2 x 3-blade folding propellers for 50hp engine, bronze	3.890,00 €
<input type="checkbox"/>	Electronic throttle control on both helmstations	10.900,00 €
NAVIGATION EQUIPMENT		
<input type="checkbox"/>	Name of boat on Lazy bag	490,00 €
<input type="checkbox"/>	Black painted mast and boom	5.700,00 €
<input type="checkbox"/>	Upgrade square main sail	1.200,00 €
<input type="checkbox"/>	Hydranet main and fore sail (replaces standard sails)	14.150,00 €
<input type="checkbox"/>	Hydranet square main sail and solent (replaces standard sails)	15.350,00 €
<input type="checkbox"/>	Code 0 55m² incl. sheets (upwind sail)	4.980,00 €
VE	Gennaker reacher 70sqm incl. sheets	3.790,00 €
<input type="checkbox"/>	Asymmetric spinnaker 123sqm incl. Sheets, with socks	5.980,00 €
VE	Bowsprit, dynema halyard, furler, blocks and stoppers (for gennaker, spinnaker)	5.990,00 €
<input type="checkbox"/>	Code 0 gear (only in combination with Gennaker gear)	1.280,00 €
VE	Electrical winch LEWMAR for mainsail halyard at helm station Stb.	3.890,00 €
<input type="checkbox"/>	Manual winch LEWMAR for mainsheet, Port.	1.590,00 €
<input type="checkbox"/>	Anchor windlass remote control with chaincounter at helm station	990,00 €
UPHOLSTERY & LIFESTYLE		
Inside range choice		
<input type="checkbox"/>	Upgrade comfort mattress (3c version)	2.100,00 €
<input type="checkbox"/>	Upgrade comfort mattress (4c version)	2.800,00 €
<input type="checkbox"/>	Saloon cushions Standard	Standard
<input type="checkbox"/>	Eden Nutmeg	
<input type="checkbox"/>	Eden Pebble	
<input type="checkbox"/>	Eden Shadow	
<input type="checkbox"/>	Eden Midnight	
<input type="checkbox"/>	Saloon cushions Ultraleather	790,00 €
<input type="checkbox"/>	White	
<input type="checkbox"/>	Beige	
<input type="checkbox"/>	Taupe	
<input type="checkbox"/>	Saloon cushions Leather	2.190,00 €
<input type="checkbox"/>	Sand	
<input type="checkbox"/>	Cappuccino	
<input type="checkbox"/>	Slate Gray	
Outside color choice:		
<input type="checkbox"/>	Eden Nutmeg	Optionnal
<input type="checkbox"/>	Eden Pebble	
<input type="checkbox"/>	Eden Shadow	
<input type="checkbox"/>	Eden Midnight	
Signature Nautitech		
<input type="checkbox"/>	Upgrade for In&Out SIGNATURE Upholstery with decorative cushions	2.390,00 €
<input type="checkbox"/>	Set of custom bedding for 3 cabin-version (including cushions and duvet)	2.250,00 €
<input type="checkbox"/>	Set of custom bedding for 4 cabin-version (including cushions and duvet)	3.000,00 €
<input type="checkbox"/>	Set of 6 bathroom towels - white with Nautitech Manta Ray embroidery (2 guests, 2 toilets and 2 baths) - unit price per set	290,00 €
<input type="checkbox"/>	Set of 6 socks for fender - Black with white Nautitech embroidery	560,00 €
<input type="checkbox"/>	Upgrade of gennaker with printing of Nautitech Manta Ray (gold) and 40 (black)	2.900,00 €
<input type="checkbox"/>	Hull decoration with Manta Ray (gold)	2.100,00 €
EXTERIOR EQUIPMENT		
Deck/Cockpit		
<input type="checkbox"/>	FLEXITEEK in cockpit and aft platforms	11.900,00 €
<input type="checkbox"/>	Frontdeck lounge. Bar/storage box with integrated cupholders, foldable 3 part cushions convertible into lounge area	4.270,00 €
VE	Full cockpit enclosure with doors	3.900,00 €
<input type="checkbox"/>	Additional sun net for cockpit enclosure (only together with cockpit enclosure)	1.410,00 €
VE	External sun shades for saloon windscreen with opening	2.030,00 €
<input type="checkbox"/>	Bimini on helmstation (per unit)	1.700,00 €
<input type="checkbox"/>	Helmstation protection cover (per unit)	530,00 €
VE	Cushions for cockpit seats and aft bench	4.410,00 €
<input type="checkbox"/>	Upgrade cockpit table convertible into lounge area (upholstery included)	1.990,00 €
<input type="checkbox"/>	Upgrade Cockpit table in natural wood 10 pers (1,73m X 0,79m)	1.660,00 €

INTERIOR EQUIPMENT		Price excl. VAT EUROS
<input type="checkbox"/>	Blinds for cabin hull windows	1.910,00 €
<input type="checkbox"/>	Desk configuration in the owner cabin	2.180,00 €
<input type="checkbox"/>	Salon dining table convertible into lounge bed (incl. cushion)	1.870,00 €
<input type="checkbox"/>	Extra berth in portside forepeak incl. mattress, gelcoat finishing, ventilation, light and access to front cabin (only with 4 Cabin version)	1.890,00 €
<input type="checkbox"/>	Extra berth in starboard forepeak incl. mattress, gelcoat finishing, ventilation, light and access to front cabin	1.890,00 €
COMFORT & APPLIANCES		
<input type="checkbox"/>	Watermaker 60 L/h 12V (brand Dessalator)	17.900,00 €
<input type="checkbox"/>	Electrical sea water pump	790,00 €
<input type="checkbox"/>	Fridge in cockpit 65L, 12V	2.700,00 €
<input type="checkbox"/>	Freezer 55L 12V	2.170,00 €
<input type="checkbox"/>	Washing machine 3kg 220V (3 cabin version only - not available in 110V)	2.590,00 €
<input type="checkbox"/>	Microwave oven 220V	330,00 €
<input type="checkbox"/>	Fans 12V (1 per cabin / 2 in saloon)	1.490,00 €
<input type="checkbox"/>	Reversible air-conditioning 230V (cooling+heating function for Owner version) Complete system with outlet in salon and one in each cabin	30.960,00 €
<input type="checkbox"/>	Reversible air-conditioning 230V (cooling+heating function for 4 cabins version) Complete system with outlet in salon and one in each cabin	33.390,00 €
<input type="checkbox"/>	Heating system, complete system with outlet in each cabin + saloon + cockpit	19.170,00 €
<input type="checkbox"/>	Electrical toilet, seawater flush (per unit - specify location)	1.100,00 €
<input type="checkbox"/>	Electrical toilet, freshwater flush (per unit - specify location)	1.250,00 €
ELECTRICITY & LIGHTING		
<input type="checkbox"/>	1 Additional service battery 140A + 1 battery charger 40 Ah	2.090,00 €
<input type="checkbox"/>	Inverter 2000W connected to boardnet incl. Switch (Additional service batterie 140A and charger 40A compulsory)	2.590,00 €
<input type="checkbox"/>	Lithium batteries 630Ah instead of AGM batteries	13.990,00 €
<input type="checkbox"/>	Indirect lighting in saloon	995,00 €
<input type="checkbox"/>	Courtesy LED lights white in cockpit and aft deck	1.300,00 €
<input type="checkbox"/>	Two LED spreader lights	1.210,00 €
<input type="checkbox"/>	Two LED spotlights under the bridgedeck	2.110,00 €
<input type="checkbox"/>	Underwaterlighting 4 x 21W white	4.290,00 €
<input type="checkbox"/>	Solar Panels 4x100W on davits	5.090,00 €
<input type="checkbox"/>	Solar Panels 4x180W on the roof	5.600,00 €
<input type="checkbox"/>	Solar Panels 8x180W on the roof	11.200,00 €
<input type="checkbox"/>	Generator Onan 6KW (starboard forepeak not compatible)	23.900,00 €
ELECTRONIQUE ET MULTIMEDIA		
<input type="checkbox"/>	Nav-Pack Cruise	14.800,00 €
	2 x B&G Triton Displays (1 x per helmstation) with Speed-, Depth-, Wind-Transducer	
	2 x B&G Zeus 9" chartplotter (stb & port helmstations) Chartplotter functionality on B&G Zeus 9" at nav station	
	B&G Autopilot, B&G Autopilot control unit (stb helmstation)	
	B&G V100 VHF incl. Antenna (nav station)	
	B&G AIS Transmitter/Receiver	
	B&G H50 wireless VHF unit (stb helmstation)	
<input type="checkbox"/>	Nav-Pack Advanced	16.880,00 €
	<i>includes Nav-Pack Cruise plus additional</i>	
	1 x extra B&G Autopilot control unit (port helmstation)	
	B&G Forward scan	
<input type="checkbox"/>	B&G 4G Radar antenna	3.190,00 €
<input type="checkbox"/>	Pre installation for TV (antenna incl. plug) in saloon	980,00 €
60 HZ OPTIONS		
<input type="checkbox"/>	Upgrade Electrical system 110V 60Hz	2.630,00 €
<input type="checkbox"/>	Inverter 2000W 110V connected to boardnet incl. Switch (Additional service batterie 140A and charger 40A compulsory)	2.610,00 €
<input type="checkbox"/>	Reversible air-conditioning 110V (cooling+heating function for Owner version) Complete system with outlet in salon and one in each cabin	36.460,00 €
<input type="checkbox"/>	Reversible air-conditioning 110V (cooling+heating function for 4 cabins version) Complete system with outlet in salon and one in each cabin	38.390,00 €
<input type="checkbox"/>	Generator Onan 7,5KVA/60Hz under 110V (starboard forepeak not compatible)	25.300,00 €
<input type="checkbox"/>	Pre installation for TV 110V (antenna incl. plug) in saloon	980,00 €

SAFETY EQUIPMENT AND DELIVERY

Price excl. VAT EUROS

<input type="checkbox"/>	Dinghy 3,1m (highfield UB310 Hypalon) with 10hp Honda outboard engine	10.880,00 €
<input type="checkbox"/>	Life raft cat. A with security pack for 10 crew (except EPIRB)	4.990,00 €
<input type="checkbox"/>	Antifouling INTERNATIONAL PRO 250 (3 layers)	4.730,00 €
<input type="checkbox"/>	Antifouling PLATINIUM (3 layers)	6.190,00 €
<input type="checkbox"/>	Copper coat	8.910,00 €
<input type="checkbox"/>	Delivery in La Rochelle incl. transport, launching, rigging (1 week Marina fees incl.)	8.950,00 €
<input type="checkbox"/>	loading in Rochefort : preparation for sea freight incl. shrink wrap, mast in 2 parts and mast cradles	6.250,00 €
<input type="checkbox"/>	Administrative papers for custom exit	480,00 €
<input type="checkbox"/>	Administrative papers for apostille or notarized document (per demande and per document)	150,00 €

INDICATIVE RETAIL PRICE LIST

All prices are in EUROS EX Works Rochefort (17300 - France) Incoterms 2020

Version S2_2023 - Valid from SEPTEMBER 1ST 2023

Date of issue : AUGUST 4TH 2023 - all previous price lists lose their validity

BASED ON BUILDER STANDARD SPECIFICATIONS AUGUST 4TH 2023

Minimal configuration required

We, Nautitech, reserve the right to modify or improve our products and to change its specifications and/or prices without notice. We, Nautitech, are not liable for errors and printing mistakes. Aforementioned prices are recommended sales prices, not contractual. All modifications of orders are subject to invoicing according to the then valid price list. Final price may be subject to a price adjustment based on a notified Index. The current price includes the Ecotax APER.

NAUTITECH CATAMARANS, 5-7 rue Hubert Pennevert, 17300 Rochefort - France

Tél : +33 (0) 546 998 292

Email : contact@nautitech.frwww.nautitechcatamarans.com

NAUTITECH 40 OPEN

TECHNICAL STANDARD SPECIFICATIONS AUGUST 4TH 2023



TECHNICAL DATAS

Length overall	11,98 m / 39'3"
Length waterline	11,94 m / 39'2"
Beam overall	6,91 m / 22'7"
Draft	1,35 m / 4'4"
Unloaded weight (approx.)	8,5 t / 18 739 lbs
Engine, drive	VP D2-30, Saildrive
Engine power	2 x 30 hp
Fuel tank	2 x 200 L / 2 x 53 gal
Water tank	2 x 300 L / 2 x 79 gal
Cabins - Heads, standard	3 or 4 - 2
Berths, standard version	6 or 8
Full batten mainsail, standard	63 m ² / 678 sq ft
Self-tacking jib, standard	28 m ² / 301 sq ft
Height of mast above water line (approx.)	20,05 m / 65'8"
Architect	MLYDG
Interior Design	Nautitech Catamarans
CE-Certification Category A (10 Pers.)	
CE-Certification Category B (10 Pers.)	
CE-Certification Category C (22 Pers.)	
CE-Certification Category D (22 Pers.)	



CONSTRUCTION

Hull and Deck made of fibreglass and polyester sandwich infusion-BAVARIA VacuTec process	■
Hull and Deck in gelcoat white	■
Coachroof in gelcoat white	■
Gold stripe on hull	■
Keel in GRP laminated and bonded to hull	■
4 x Double Hull windows including opening porthole	■
2 x Hull windows including opening porthole	■

RIG AND DECK HARDWARE

Aluminium deck stepped mast, anodised, with two spreaders sets	■
Aluminium boom, anodised	■
Anodized aluminium forward front beam	■
Running rigging	■
Mainsheet traveller on the coachroof	■
4 x Lewmar Evo aluminium winches 2-gear, self-tailing , 3 in cockpit, 1 at mast foot	■
2 x Winches handles and pockets	■

SAILS

Full batten mainsail (3 reef lines), Dacron	■
Self-tacking Solent in Dacron, incl. UV protection (Grey)	■

DECK/ STERN PLATFORM

Guardrail on hull sides with stainless steel wires	■
2 x Forward pulpits with seats in inox	■
6 x Mooring cleats, aluminium	■
Anodised aluminium forward beam	■
Two net lashed to hull and front beam	■
Bow anchor locker and storage	■
8 x openable deck hatches (1 additionnal in the 3 cabin version)	■

PROPULSION / STEERING

2 x 30hp diesel engines Volvo Penta (Saildrive)	■
2 x 3-blade fixed aluminium propellers	■
Two helmstand with compass and stainless wheels	■
GRP rudders with stainless steel stock	■
Emergency tiller	■
Access to engine room via transom hatches	■

ELECTRICAL MANAGEMENT SYSTEM

12 v electrical panel in the saloon portside	■
Alternators 115Ah (1 x per engine)	■
1 battery per engine 12V/90Ah	■
Battery for service 1 x 12V/140Ah	■
Electrical switch for batteries (service and engines)	■

LIGHTS

LED navigation lights and anchor light	■
Spot LED ceiling lights in cabins, bathrooms	■
Ceiling LED strips ceilinglights in saloon, cockpit and cabins	■

PLUMBING

Electric and manual bilge pumps in both hulls	■
Electric bilge pumps in both engine compartments	■
2 x 300L freshwater tanks	■
Freshwatersystem with electrical pressure pump	■
Warm water boiler via engine-cooling, 40L	■

COCKPIT / TRANSOM

Spacious open style cockpit, 2 large benches on starboard and portside
Aft bench with storage
Double sliding door to salon
Teak grating over cockpit drainage
Large cockpit lockers
Aft pushpits
Foldable bathing ladder on starboard



COACHROOF

2 stainless steel handrails on coachroof
Top zenital window in coachroof



INTERIOR LAYOUTS

Available Versions

4 Cabins

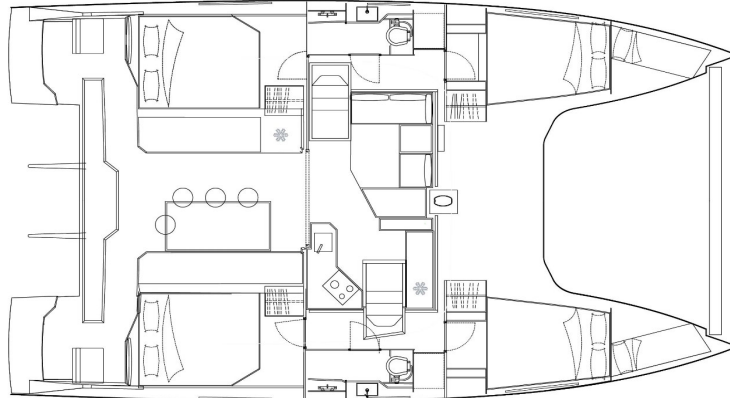

3 Cabins - Owner Version

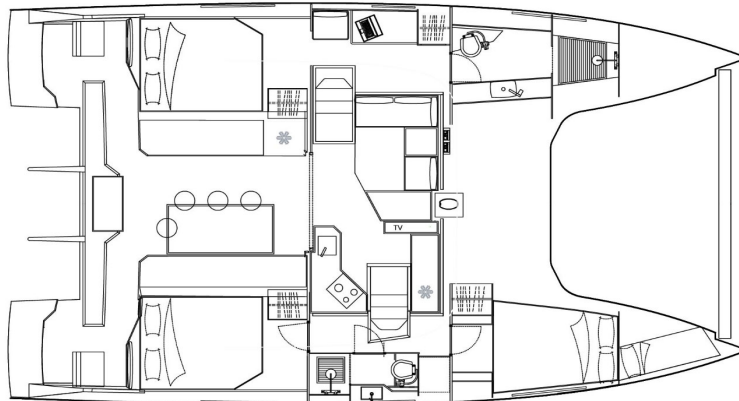

Generalities

Interior woodwork in Alpi White oak
Resopal Elm Flooring
Headliner Silvertex ICE

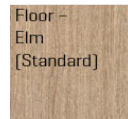

Saloon

Comfortable saloon area with modern lounge style sofas
Fixed dining table
Storage under the seats
Fabric upholstery Eden (3 color choice)
Stainless steel handrail at companionway
LED reading lights at the chart table
Central storage drawer for bottles
Deckhouse windscreen with 2 integrated hatches
2 x opening roof hatches

■
■
■
■
■
■
■
■

Galley

Multiple storage cupboards
Large white worktop
Refrigerator 130L 12V in front galley
Aft galley with :
- Gas oven
- 3 burner gas stove
- Double sink with mixer tap
- Waste bin
Overhead locker in galley, starboard

■
■
■
■
■
■
■
■

Cabins

Aft cabins with Double bed (160*200cm)
Forward cabins with Double bed (150*195cm)
Mattresses Light Grey
Wood finish at bed front
Underbed storage
Storage locker in hull passageway
Double hull windows in each cabin
Side lining around the window White
Head Side, Liners, Bed Surround, Head Board ICE and Macadamia silvertex
Several spacious lockers and shelves for storage
LED reading lights headboard
Opening porthole in aft cabins above bed heads

■
■
■
■
■
■
■
■
■
■
■
■
■

Owner Cabins equipment (in addition to above cabin description)

Access from the saloon through a sliding door
Working area : Fold down desk with seat
Shelf on outer side of hull
Large lockers with three doors

■
■
■
■

Head stb

Sink with mixing tap
Black worktop
Cabinet for storage
Towel rail
Mirror
Holding tank 45L (one per hull)
Pump-toilet, manual
Opening portlight in hull window
Opening deck hatch

■
■
■
■
■
■
■
■
■

Owner head

Separate shower cabin
Black worktop
Cabinet for storage
Mirror
Towel rail
Sink with mixing tap
Holding tank 45L (one per hull)
Manual pump toilet, disposal via seacock
Opening portlight in hull window
2 x Opening deck hatch (above shower cabin and bathroom)

■
■
■
■
■
■
■
■
■
■

The brochure is intended for advertisement only and is not part of a contract, warranty or of an offer. We reserve the right to modify or improve our products and to change its specifications without notice. We are not liable for errors and printing mistakes.

Version S2_2023 - Valid from SEPTEMBER 1ST 2023
Date of issue : AUGUST 4TH 2023 - all previous price lists lose their validity

